



PARALIFT





PARALIFT: REACH FOR A SAFE CHOICE.

Our paralifts are uniquely designed for handling shortwood, while maintaining high visibility for safe and efficient throughput.

- Over 20 years of history with Paralift.
- Unsurpassed reliability and performance.
- Simplicity of installation allows you to take advantage of Pierce quality on the carrier of your choice.
- The ability to tailor your paralift to meet your logyard requirements.

Used in:

- Saw mills.
- Pulp mills.
- Paper mills.
- OSB plants.
- Plywood mills.
- Transfer yards.
- Shipyards.

Use the Paralift in several applications:

- Unloading trucks and railcars.
- Feeding mill.
- Hauling.
- Reclaiming.
- Sorting and selection.
- Stacking.
- Decking.
- Other: steel pipes, railroad ties, scrap metal, rocks poles, lumber, etc.



PIERCE
Denharco

45-150 PARALIFT: GRAPPLE OPTIONS

			RL11	RL22	RL24
GRAPPLE AREA		FT.2	11.98	24.08	26.3
		m2	1.1	2.2	2.4
A	GRAPPLE WEIGHT	LB	5125	5608	5774
		KG	2330	2549	2625
B	CROSS-SECTION, CLOSED	IN	52.5	72	73.5
		MM	1334	1829	1867
C	SPAN, CLOSED	IN	68.5	89	90
		MM	1740	2261	2286
D	OPENING	IN	100.5	137.5	137
		MM	2553	3493	3480
E	SPAN, OPEN	IN	104.5	141.5	141
		MM	2654	3594	3581
F	HEIGHT, CLOSED	IN	101	123.5	123.5
		MM	2565	3137	3137
G	HEIGHT, OPEN	IN	76	88.5	89.5
		MM	1930	2248	2273
	WIDTH	IN	48	36	36
		MM	1219	914	914
RECOMMENDED LOG LENGTH		FT	16	10	10
		M	5	3	3

Option weight not included in grapple weight.
Contact Pierce for alternate grapple sizes/recommendations.

INCLUDES:

- Bolt-on base bracket.
- Screened main boom and (2) cylinders.
- Auxiliary boom and (2) cylinders.
- Mechanical swivel joint.
- Fore/aft retaining cylinders with lock position.
- Hydraulic cylinders and controls.
- Central lubrication system.
- Railings, frame lights, cabin mirror and light modifications.
- Heavy-duty front steel fenders.
- Hydraulic & electrical installation kit.
- Real time pressure display from OEM computer (available on certain brands only).

HEAVY-DUTY GRAPPLES WITH GEAR ROTATION SYSTEM:

- RL11 (RE150-4)
- RL22 (RE150-2)
- RL24 (RE175-2)

ALL GRAPPLES FEATURE:

- Dual axis grapple pivot.
- Swing motor armor.
- Inside grapple arm plating.
- Integrated 360° rotation.

OPTIONS:

- Grapple retaining chain.
- Front grapple bumper.
- Mechanical kit with or without friction dampener.
- Load sensitive grapple dampener (fore/aft).
- Log pusher.
- LED work light package.

LOADER EQUIPPED WITH:

- Bare front frame [no boom and arm (linkage), cylinder, pin, bucket, etc.]
- Maximum permissible counterweight.
- Forestry configuration.
- 3 spool control (attachment) valve.
- 2 axis joysticks for attachment control.
- Rigid wall 26.5" X 25 rated L3-20 ply tires.

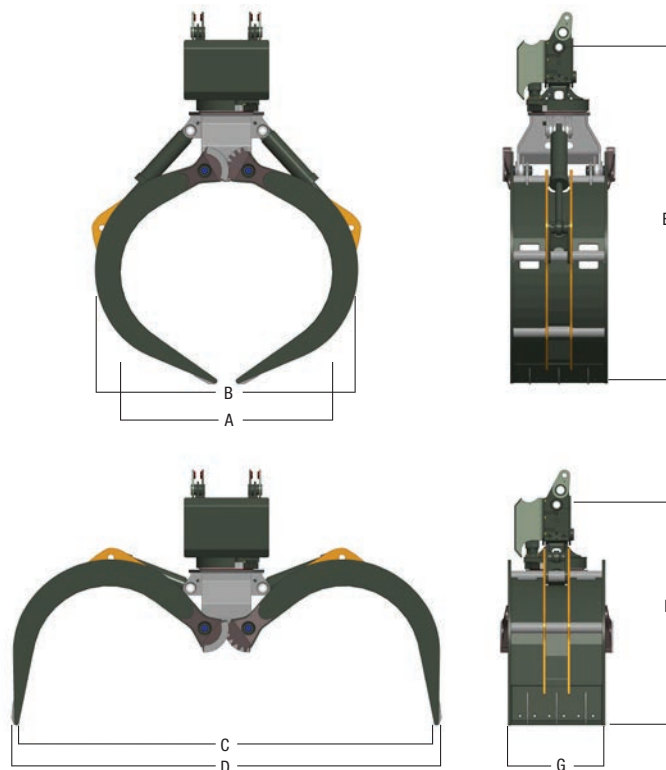

55-225 PARALIFT: GRAPPLE OPTIONS

		RE225-4	RE200-2	RE225-2	RE225-2HDB	RE250-2	RE275-2
GRAPPLE AREA	FT.2	18	34	36	36	41	45
	m ²	1.7	3.2	3.3	3.3	3.8	4.2
A GRAPPLE WEIGHT	LB	7195	7659	8510	9368	9361	9829
	KG	3270	3481	3868	4258	4255	4468
B CROSS-SECTION, CLOSED	IN	57	85	89	89	93.5	96
	MM	1448	2159	2261	2261	2375	2438
C SPAN, CLOSED	IN	88	104	111.5	111.5	115	121
	MM	2235	2642	2832	2832	2921	3073
D OPENING	IN	120.5	170	171.5	171.5	179.5	186
	MM	3061	4318	4356	4356	4559	4724
E SPAN, OPEN	IN	117.5	173	177.5	177.5	183.5	196
	MM	2985	4394	4509	4509	4661	4978
F HEIGHT, CLOSED	IN	107	139	140	140	143	148
	MM	2718	3531	3556	3556	3632	3759
G HEIGHT, OPEN	IN	96	95.5	97	97	95.5	98
	MM	2438	2426	2464	2464	2426	2489
WIDTH	IN	40	40	40	40	40	39.5
	MM	1016	1016	1016	1016	1016	1003
RECOMMENDED LOG LENGTH	FT	16	8	8	8	8	8
	M	5	3	3	3	3	3

Option weight not included in grapple weight.
Contact Pierce for alternate grapple sizes/recommendations.

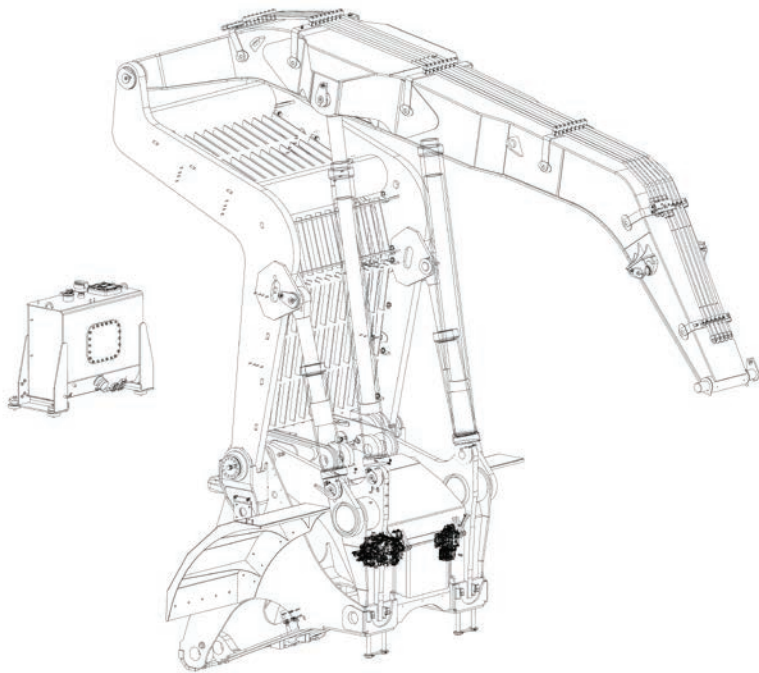

PARALIFT

PARALIFT



INCLUDES:

- Bolt-on base bracket.
- Screened main boom and (2) cylinders.
- Auxiliary boom and (2) cylinders.
- Mechanical swivel joint.
- Fore/aft retaining cylinders with lock position.
- Hydraulic cylinders and controls.
- Central lubrication system.
- Railings, frame lights, cabin mirror and light modifications.
- Heavy-duty front steel fenders.
- Hydraulic and electrical installation kit.
- Real time pressure display from OEM computer (available on certain brands only).

HEAVY-DUTY GRAPPLES WITH GEAR ROTATION SYSTEM:

- RE225-4
- RE200-2
- RE225-2
- RE225-2HDB
- RE250-2
- RE275-2

ALL GRAPPLES FEATURE:

- Dual axis grapple pivot.
- Swing motor armor.
- Inside grapple arm plating.
- Integrated 360° rotation.

OPTIONS:

- Grapple retaining chain.
- Front grapple bumper.
- Mechanical kit with or without friction dampener.
- Load sensitive grapple dampener (fore/aft).
- Log pusher.
- LED work light package.

LOADER EQUIPPED WITH:

- Bare front frame [no boom and arm (linkage), cylinder, pin, bucket, etc.]
- Maximum permissible counterweight.
- Forestry configuration.
- 3 spool control (attachment) valve.
- 2 axis joysticks for attachment control.
- Rigid wall 29.5" X 25 rated L4-22 ply tires.

EXCLUSIVELY

P
PIERCE



Pierce Pacific Manufacturing, Inc.

4424 NE 158th
Portland, Oregon 97230 USA

Post Office Box 30509
Portland, Oregon 97294 USA

Telephone: 503.808.9110
Toll Free: 800.760.3270
Fax: 503.808.9111

Distribution Warehouses
Edmonton, Alberta Canada
Jackson, Mississippi USA

www.piercepacific.com